

UNIMAC CAST IRON VALVES

Cast Iron Globe Valve

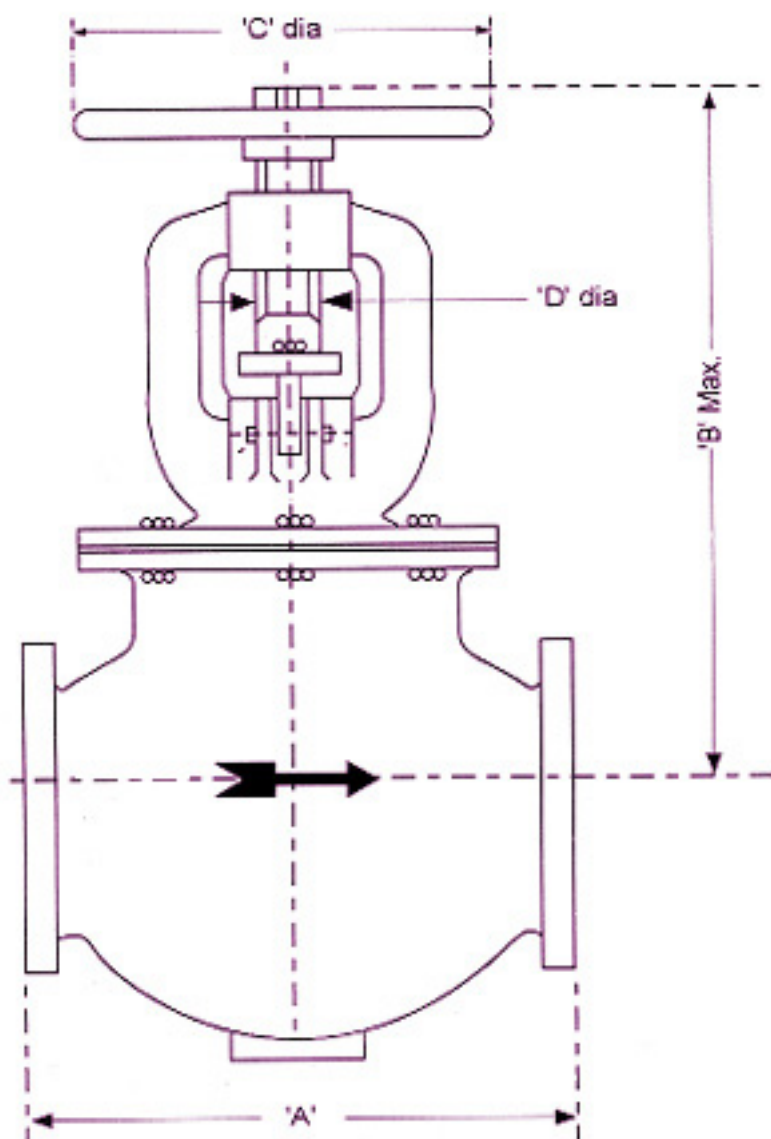

DESIGN STANDARD	IS : 9338, ASA : 125, BS : 5152, DIN : 3356.
CONSTRUCTION	OUTSIDE SCREW RISING SPINDLE (YOKE TYPE / STAY ROD TYPE).
SIZE/RATING	15 MM TO 600 MM. / PN - 1 MPa TO PN - 1.6 MPa.
APPLICATION	WATER, SEWAGE, GAS, OIL, CHEMICAL.
OPERATION	MANUAL, ELECTRICAL, PNEUMATIC, HYDRAULIC.
TRIM MATERIAL	DIFFERENT MATERIAL OF CONSTRUCTION TO SUIT REQUIREMENTS.



VALVE SIZE	A	B	C	D	APPX. WT IN KG	
15	131	205	200	100	14	8
20	151	206	200	100	14	9
25	161	208	200	120	14	10
32	181	210	210	120	14	13
40	201	252	240	140	16	17
50	231	265	250	140	16	26
65	291	325	305	160	18	30
80	311	340	315	180	20	42
100	351	390	360	200	22	52
125	401	460	420	250	24	85
150	481	510	465	320	26	100
200	601	635	575	400	32	200
250	731	775	700	400	36	225
300	851	890	800	400	36	285
350	1001	1050	950	500	40	380
400	1101	1220	1100	500	44	600
450	1261	1335	1200	500	44	800
500	1401	1500	1350	640	50	1000
600	1701	1780	1600	640	50	1400

- All dimensions are in mm.
- We can supply any intermediate size.
- End Connection as per customer's requirement or any International std.
- Trim material depends upon Service medium or Customer's choice.

Note : Due to constant up gradation, dimensions are subject to change by the manufacturer.